

# FB SERIES FABRICATED BASKET STRAINERS

PRESSURES TO 3705 PSIG (255 BARG)  
TEMPERATURES TO 800°F (427°C)

- Multiple and custom body configurations for tight installation, performance and economy
- Multi-baskets minimize downtime
- Stainless steel perforated baskets are standard
- Cover lifting lug standard on sizes 10" and larger
- Bottom/blowdown outlet is standard
- Drain connection with plug furnished as standard

## APPLICATIONS

- Water, Oil Systems
- Other Liquid Systems
- Protection of Pumps, Meters, Valves, etc.

## MODELS

- FB1 - Standard Body
- FB2 - Undersized Body
- FB3 - Oversized Body
- FB4 - Low Profile Body w/Pleated Bskt
- FB5 - Low Profile Body w/Multiple Bskts

## APPLICABLE CODES

- Designed/Manufactured to meet ANSI B31.1, ANSI B31.3 or ANSI B31.4 and/or ASME Section VIII, Div. I.
- CRN available in all provinces
- Welders Certified to ASME Section IX

## OPTIONS

- Other materials, sizes and/or configurations
- Quick Opening Covers - *See page 468*
- Other screen, mesh or wedgewire - *See page 466*
- Vent and/or differential pressure connections
- "U" stamped vessels
- Steam jacketing
- Backflush or backwash
- NACE MR010-75 Certification
- External/internal coatings
- Offset inlet/outlet Nozzles
- 600# flanges and higher
- Pleated Baskets for higher Open Area Ratios
- Consult factory for other options

## PRESSURE/TEMPERATURE CHART

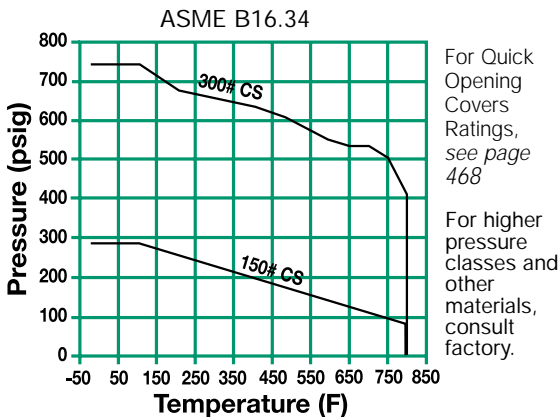

## FB Series Ordering Code

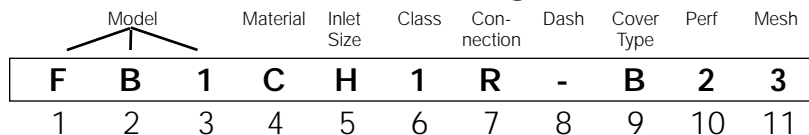

<p><b>Model</b> - Position 1 - 3</p> <p>FB1 - Standard Body FB2 - Undersized Body FB3 - Oversized Body FB4 - Low Profile Body w/Pleated Bskt FB5 - Low Profile Body w/Multiple Bskts FBZ - Custom Configuration</p> <p><b>Material</b> - Position 4</p> <p>C - Carbon Steel L - Low Temp CS V - 304 SS T - 316 SS M - Monel H - Hastelloy Z - Other</p>	<p><b>Inlet Size</b> - Position 5</p> <p>H - 2 J - 2½ K - 3 M - 4 N - 5 P - 6 Q - 8 R - 10 S - 12 T - 14 U - 16 V - 18 W - 20 X - 22 Y - 24 1 - 28 2 - 30 3 - 36 4 - 40 Z - Other</p>	<p><b>Class</b> - Position 6</p> <p>1 - 150 3 - 300 4 - 600 5 - 900 Z - Other</p> <p><b>Connection</b> - Position 7</p> <p>B - Butt weld<sup>1</sup> F - Flat Face Flg N - NPT J - Ring Joint Flg R - Raised Face Flg K - Socket weld Z - Other</p> <p><b>Dash</b> - Position 8</p> <p>1. For Butt weld connections please specify mating pipe schedule</p>	<p><b>Cover Type</b> - Position 9</p> <p>B - Bolted C - Bolted w/C-Clamp D - Bolted w/Davit J - Bolted w/Hinge H - T - Bolt Hinged T - Threaded Hinged Y - Yoke Hinged Z - Other</p> <p>For any variations, use the part numbering system above but clearly indicate the additional requirements.</p>	<p><b>Perf</b> - Position 10</p> <p><b>304 SS Material<sup>2</sup></b></p> <p>A - None B - 3/64" 1 - 1/32" 2 - 1/16" 3 - 3/32" 4 - 1/8" 5 - 5/32" 6 - 3/16" 7 - 7/32" 8 - 1/4" 9 - 3/8" Z - Other</p> <p>2. For other screen material, contact factory.</p>	<p><b>Mesh<sup>2</sup></b> - Position 11</p> <p>A - None 1 - 10 2 - 20 3 - 30 4 - 40 5 - 50 6 - 60 7 - 80 8 - 100 9 - 120 Z - Other</p>
---	---	---	---	---	---

# FB SERIES – FB1 FABRICATED BASKET STRAINERS

## SPECIFICATION

Strainer shall be designed and manufactured to meet ANSI B31.1, ANSI B31.3 or ANSI B31.4 and/or ASME Section VIII Div. I. The Strainer body shall be fabricated steel or other specified material and inlet/outlet connections shall be in line. The Strainer shall have a single basket with a slant top. The Strainer shall have a bottom blowdown outlet. The screen shall be size \_\_\_\_ perforated stainless steel. The Strainer shall have an inlet size of \_\_\_\_ and open area ratio of \_\_\_\_\_. The Basket Strainer shall be SSI FB \_\_\_\_\_.

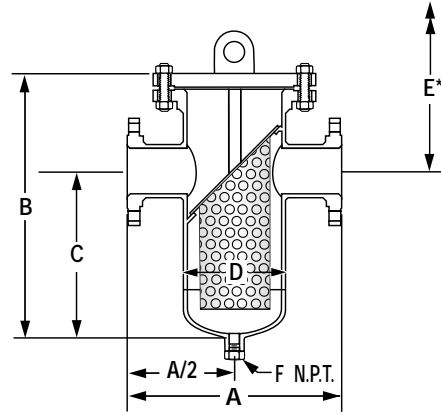

## MATERIALS OF CONSTRUCTION (Carbon Steel Shown<sup>†</sup>)

Body	A53E/B or A106-B
Nozzles	A53E/B or A106-B
Flanges	A105
Heads	A234-WPB or A516-70
Reinforcement Pads <sup>2</sup>	A516-70
Couplings	A105
Plug	A105
Basket <sup>1</sup>	304 SS
Gasket <sup>1</sup>	304 SS Spiral Wound
Stud	A193-B7
Nut	A194-2H

<sup>†</sup> Other Materials Available. Consult factory.

1. Recommended Spare Parts.

2. When required.

Material specification will change when NACE MR01-75 is specified.

Standard cover is bolted.

Cover lifting lug standard on 10" sizes and larger.

Class 150# and 300# flanges are standard.

Class 600# and higher available on request.

\*Distance required for basket removal.

Connections\*: 2" – 24"  
RF, FF, RTJ Flanged or Butt weld

\*Larger sizes available. Consult Factory.

For Butt weld connection please specify mating pipe schedule.

## SCREEN OPENINGS

SIZE	STANDARD SCREEN	MATERIALS
2" – 12"	1/8 Perf.	304 SS
14" – 24"	3/16 Perf.	304 SS

## FB1 DIMENSIONS inches (mm) AND WEIGHTS pounds (kg)

For 600#. 900# and 1500# dimensions and weights contact factory.

Inlet/Outlet	Body	A		B		C		D	E		F	Weight			
		Class 150	Class 300	Class 150	Class 300	Class 150	Class 300		Class 150	Class 300		Class 150		Class 300	
												Cover <sup>1</sup>	Unit	Cover <sup>1</sup>	Unit
2 (50)	6 (150)	12 (305)	14 <sup>7</sup> / <sub>8</sub> (378)	18 <sup>5</sup> / <sub>8</sub> (473)	22 (559)	11 <sup>1</sup> / <sub>8</sub> (283)	12 (305)	6 <sup>5</sup> / <sub>8</sub> (168)	25 (635)	28 (711)	1/2 (15)	26 (12)	85 (39)	50 (23)	195 (88)
3 (80)	8 (200)	14 (356)	16 <sup>1</sup> / <sub>2</sub> (419)	20 <sup>1</sup> / <sub>2</sub> (521)	25 (635)	12 <sup>1</sup> / <sub>2</sub> (318)	15 <sup>3</sup> / <sub>4</sub> (400)	8 <sup>5</sup> / <sub>8</sub> (219)	28 <sup>1</sup> / <sub>2</sub> (724)	34 <sup>1</sup> / <sub>4</sub> (870)	3/4 (20)	45 (20)	140 (64)	81 (37)	250 (113)
4 (100)	8 (200)	16 (406)	18 <sup>5</sup> / <sub>8</sub> (473)	22 <sup>1</sup> / <sub>4</sub> (565)	26 (660)	14 (356)	15 <sup>7</sup> / <sub>8</sub> (403)	8 <sup>5</sup> / <sub>8</sub> (219)	30 <sup>1</sup> / <sub>2</sub> (775)	36 <sup>1</sup> / <sub>8</sub> (918)	1 (25)	45 (20)	145 (66)	81 (37)	300 (136)
5 (125)	10 (250)	18 (457)	20 <sup>1</sup> / <sub>4</sub> (514)	24 <sup>1</sup> / <sub>4</sub> (616)	28 (711)	17 (432)	17 <sup>1</sup> / <sub>8</sub> (435)	10 <sup>3</sup> / <sub>4</sub> (273)	30 <sup>1</sup> / <sub>2</sub> (775)	38 <sup>7</sup> / <sub>8</sub> (988)	1 (25)	70 (32)	160 (73)	125 (57)	400 (181)
6 (150)	10 (250)	20 (508)	24 <sup>1</sup> / <sub>2</sub> (622)	27 (686)	30 <sup>3</sup> / <sub>4</sub> (781)	17 (432)	19 <sup>1</sup> / <sub>8</sub> (486)	10 <sup>3</sup> / <sub>4</sub> (273)	36 (914)	42 <sup>3</sup> / <sub>8</sub> (1076)	1 (25)	70 (32)	205 (93)	125 (57)	480 (218)
8 (200)	12 (300)	22 (559)	24 <sup>7</sup> / <sub>8</sub> (632)	32 (813)	35 <sup>1</sup> / <sub>2</sub> (902)	21 (533)	22 (559)	12 <sup>3</sup> / <sub>4</sub> (324)	43 (1092)	55 <sup>3</sup> / <sub>4</sub> (1416)	1 <sup>1</sup> / <sub>2</sub> (40)	110 (50)	420 (191)	185 (84)	681 (309)
10 (250)	16 (400)	32 (813)	35 <sup>3</sup> / <sub>8</sub> (899)	41 <sup>1</sup> / <sub>2</sub> (1054)	42 <sup>1</sup> / <sub>2</sub> (1080)	25 (635)	27 <sup>1</sup> / <sub>4</sub> (692)	16 (406)	58 (1473)	57 <sup>1</sup> / <sub>4</sub> (1454)	1 <sup>1</sup> / <sub>2</sub> (40)	180 (82)	650 (295)	295 (134)	1100 (499)
12 (300)	18 (450)	35 (889)	39 <sup>3</sup> / <sub>8</sub> (1000)	44 <sup>3</sup> / <sub>4</sub> (1137)	47 <sup>3</sup> / <sub>4</sub> (1213)	28 (711)	30 <sup>3</sup> / <sub>8</sub> (772)	18 (457)	61 <sup>1</sup> / <sub>2</sub> (1562)	65 <sup>1</sup> / <sub>8</sub> (1654)	1 <sup>1</sup> / <sub>2</sub> (40)	220 (100)	1205 (547)	395 (179)	1650 (748)
14 (350)	20 (500)	37 (940)	41 <sup>1</sup> / <sub>2</sub> (1054)	48 <sup>3</sup> / <sub>4</sub> (1238)	49 <sup>5</sup> / <sub>8</sub> (1260)	33 (838)	33 (838)	20 (508)	64 <sup>1</sup> / <sub>2</sub> (1638)	72 (1829)	2 (50)	285 (129)	1600 (726)	505 (229)	2600 (1179)
16 (400)	24 (600)	42 (1067)	47 <sup>1</sup> / <sub>2</sub> (1207)	54 <sup>1</sup> / <sub>4</sub> (1378)	60 (1524)	36 (914)	38 <sup>7</sup> / <sub>8</sub> (988)	24 (610)	72 <sup>1</sup> / <sub>2</sub> (1842)	81 <sup>1</sup> / <sub>8</sub> (2061)	2 (50)	430 (195)	1965 (891)	790 (358)	2750 (1247)
18 (450)	24 (600)	46.5 (1181)	*	60 (1524)	*	40 (1016)	*	24 (610)	80 (2032)	*	2 (50)	430 (195)	2200 (998)	*	*
20 (500)	30 (750)	52 (1321)	*	68 (1727)	*	46 (1168)	*	30 (762)	90 (2286)	*	2 (50)	965 (438)	3200 (1452)	*	*
24 (600)	36 (900)	64 (1626)	*	82 <sup>3</sup> / <sub>4</sub> (2102)	*	55 (1397)	*	36 (914)	110 <sup>1</sup> / <sub>2</sub> (2807)	*	2 (50)	1540 (699)	4500 (2041)	*	*

Dimensions shown are for reference only. Consult factory for certified prints when required.

\* Consult factory.

1. Weight and dimension with Bolted Cover.

# FB SERIES – FB2 FABRICATED BASKET STRAINERS

## SPECIFICATION

Strainer shall be designed and manufactured to meet ANSI B31.1, ANSI B31.3 or ANSI B31.4 and/or ASME Section VIII Div. I. The Strainer body shall be fabricated steel or other specified material and inlet/outlet connections shall be in line. The Strainer shall have a single basket with a slant top. The Strainer shall have a bottom blowdown outlet. The screen shall be size \_\_\_\_ perforated stainless steel. The Strainer shall have an inlet size of \_\_\_\_ and open area ratio of \_\_\_\_\_. The Basket Strainer shall be SSI FB \_\_\_\_\_.

## MATERIALS OF CONSTRUCTION (Carbon Steel Shown†)

Body	A53E/B or A106-B
Nozzles	A53E/B or A106-B
Flanges	A105
Heads	A234-WPB or A516-70
Reinforcement Pads <sup>2</sup>	A516-70
Couplings	A105
Plug	A105
Basket <sup>1</sup>	304 SS
Gasket <sup>1</sup>	304 SS Spiral Wound
Stud	A193-B7
Nut	A194-2H

† Other Materials Available. Consult factory.

1. Recommended Spare Parts.

2. When required.

Material specification will change when NACE MR01-75 is specified.

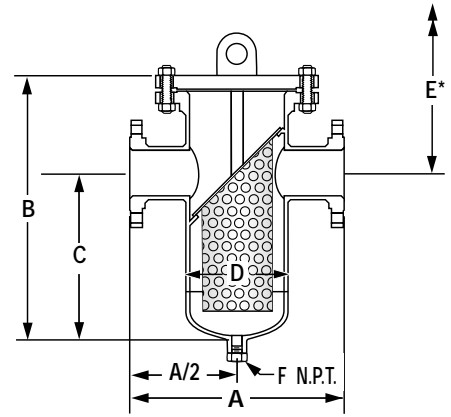

Standard cover is bolted.

Cover lifting lug standard on 10" sizes and larger.

Class 150# and 300# flanges are standard.

Class 600# and higher available on request.

\*Distance required for basket removal.

Connections\*: 2" – 24"  
RF, FF, RTJ Flanged or Buttweld

\*Larger sizes available. Consult Factory.  
For Buttweld connection please specify mating pipe schedule.

## SCREEN OPENINGS

SIZE	STANDARD SCREEN	MATERIALS
2" – 12"	1/8 Perf.	304 SS
14" – 24"	3/16 Perf.	304 SS

## FB2 DIMENSIONS inches (mm) AND WEIGHTS pounds (kg)

For 600#, 900# and 1500# dimensions and weights contact factory.

Inlet/Outlet	Body	A		B		C		D	E		F	Weight-150#		Weight-300#	
		150	300	150	300	150	300		150	300		Cover <sup>1</sup>	Unit	Cover <sup>1</sup>	Unit
2	4	10 (254)	12¾ (324)	14¾ (378)	20 (508)	8¾ (226)	12 (305)	4½ (114)	22¾ (562)	26 (660)	½ (13)	17 (7.7)	34 (15.4)	28 (12.7)	50 (22.7)
3	6	13½ (343)	11½ (292)	19¾ (486)	18¾ (480)	11¾ (295)	9 (229)	6¾ (168)	20¾ (527)	21¾ (552)	½ (13)	26 (11.8)	106 (48.1)	50 (22.7)	160 (72.6)
4	6	14 (356)	12¾ (308)	17¾ (454)	19 (483)	10¾ (270)	11¾ (287)	6¾ (168)	21¾ (536)	21¾ (543)	½ (13)	26 (11.8)	114 (51.7)	50 (22.7)	175 (79.4)
6	8	14¾ (378)	15¾ (403)	22¾ (562)	23¾ (607)	12½ (318)	12½ (318)	8¾ (219)	27¾ (692)	29¾ (754)	¾ (19)	45 (20.4)	140 (63.5)	81 (36.7)	225 (102.0)
8	10	18 (457)	24¾ (622)	30¾ (773)	30¾ (781)	19¾ (495)	19¾ (486)	10¾ (273)	36¾ (917)	35¾ (908)	1 (25)	70 (31.7)	350 (158.7)	125 (56.7)	480 (217.7)
10	12	20 (508)	25¾ (654)	36¾ (927)	36¾ (937)	21 (533)	21 (533)	12¾ (324)	32¾ (819)	45¾ (1153)	1½ (38)	110 (49.9)	400 (181.4)	185 (83.9)	800 (362.8)
12	14	26¾ (667)	27¾ (702)	37¾ (956)	39¾ (1010)	22 (559)	21 (533)	14 (356)	46¾ (1191)	50¾ (1281)	1½ (38)	139 (63.0)	595 (269.8)	241 (109.3)	930 (421.8)
14	16	30 (762)	*	41¾ (1057)	*	26 (660)	*	16 (406)	46¾ (1178)	*	1½ (38)	180 (81.6)	1208 (547.8)	295 (133.8)	*
16	20	34 (864)	*	45¾ (1162)	*	30 (762)	*	20 (508)	55 (1397)	*	2 (51)	285 (129.3)	1900 (861.7)	505 (229.0)	*
18	20	38¾ (975)	*	48.12 (1222)	*	28 (711)	*	20 (508)	59¾ (1518)	*	2 (51)	285 (129.3)	1965 (891.2)	505 (229.0)	*
20	24	40¾ (1035)	*	55.63 (1413)	*	32 (813)	*	24 (610)	66¾ (1689)	*	2 (51)	430 (195.0)	2600 (1179.1)	790 (358.3)	*
24	30	45¾ (1149)	*	62.88 (1597)	*	38 (965)	*	30 (762)	79 (2007)	*	2 (51)	965 (437.6)	4000 (1814.1)	*	*

Dimensions shown are for reference only. Consult factory for certified prints when required.

\* Consult factory.

1. Weight and dimensions with Bolted Cover.

# FB SERIES – FB3 FABRICATED BASKET STRAINERS

## SPECIFICATION

Strainer shall be designed and manufactured to meet ANSI B31.1, ANSI B31.3 or ANSI B31.4 and/or ASME Section VIII Div. I. The Strainer body shall be fabricated steel or other specified material and inlet/outlet connections shall be in line. The Strainer shall have a single basket with a slant top. The Strainer shall have a bottom blowdown outlet. The screen shall be size \_\_\_\_ perforated stainless steel. The Strainer shall have an inlet size of \_\_\_\_ and open area ratio of \_\_\_\_\_. The Basket Strainer shall be SSI FB \_\_\_\_\_.

## MATERIALS OF CONSTRUCTION (Carbon Steel Shown<sup>†</sup>)

Body .....	A53E/B or A106-B
Nozzles .....	A53E/B or A106-B
Flanges .....	A105
Heads .....	A234-WPB or A516-70
Reinforcement Pads <sup>2</sup> .....	A516-70
Couplings .....	A105
Plug .....	A105
Basket <sup>1</sup> .....	304 SS
Gasket <sup>1</sup> .....	304 SS Spiral Wound
Stud .....	A193-B7
Nut .....	A194-2H

† Other Materials Available. Consult factory.

1. Recommended Spare Parts.

2. When required.

Material specification will change when NACE MR01-75 is specified.

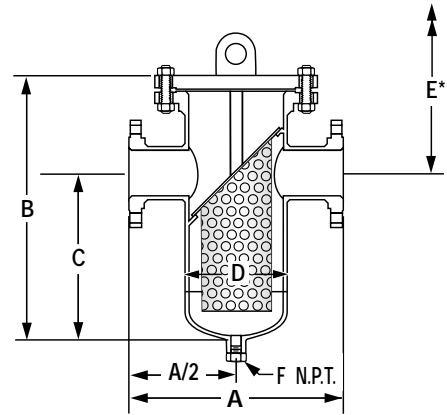

Standard cover is bolted.

Cover lifting lug standard on 10" sizes and larger.

Class 150# and 300# flanges are standard.

Class 600# and higher available on request.

\*Distance required for basket removal.

Connections<sup>3</sup>: 2" – 20"  
RF, FF, RTJ Flanged or Buttweld

3. Larger sizes available. Consult Factory.  
For Buttweld connection please specify mating pipe schedule.

## SCREEN OPENINGS

SIZE	STANDARD SCREEN	MATERIALS
2" – 12"	1/8 Perf.	304 SS
14" – 24"	3/16 Perf.	304 SS

## FB3 DIMENSIONS inches (mm) AND WEIGHTS pounds (kg)

For 300#, 600#, 900# and 1500# dimensions and weights contact factory.

Inlet	Body	A	B <sup>4</sup>	C	D	E	F	Weight-150#	
								Cover	Unit
2	8	15 (381)	22¼ (565)	14 (356)	8⅝ (219)	25 <sup>15</sup> / <sub>16</sub> (659)	½ (13)	45 (20)	135 (61)
3	10	22⅝ (575)	26⅞ (683)	15⅞ (403)	10¾ (273)	32⅝ (829)	½ (13)	70 (32)	150 (68)
4	10	22⅝ (575)	26⅞ (683)	15⅞ (403)	10¾ (273)	32⅝ (829)	½ (13)	70 (32)	160 (73)
6	12	25 (635)	32 (813)	21 (533)	12¾ (324)	37⅞ (943)	¾ (19)	110 (50)	300 (136)
8	14	28 (711)	37 (940)	23 (584)	14 (356)	44⅞ (1132)	1 (25)	139 (63)	520 (236)
10	18	36 (914)	47⅞ (1197)	30⅞ (772)	18 (457)	53 <sup>11</sup> / <sub>16</sub> (1364)	1½ (38)	220 (100)	1150 (523)
12	20	37 (940)	46¼ (1175)	31 (787)	20 (508)	52⅞ (1343)	1½ (38)	285 (129)	1500 (682)
14	24	42 (1067)	56⅞ (1426)	34½ (876)	24 (610)	66⅞ (1686)	1½ (38)	430 (195)	1850 (841)
16	30	52 (1321)	72½ (1842)	49 (1245)	30 (762)	82½ (2096)	2 (51)	965 (438)	2800 (1273)
18	30	52 (1321)	72½ (1842)	49 (1245)	30 (762)	82½ (2096)	2 (51)	965 (438)	3050 (1386)
20	36	64 (1626)	88⅞ (2251)	60 (1524)	36 (914)	99¼ (2534)	2 (51)	1540 (699)	4000 (1909)

Dimensions shown are for reference only. Consult factory for certified prints when required.

\* Consult factory.

4. Weight and dimensions with Bolted Cover.

FB3 FABRICATED  
BASKET STRAINERS

# FB SERIES – FB4 FABRICATED BASKET STRAINERS

## SPECIFICATION

Strainer shall be designed and manufactured to meet ANSI B31.1, ANSI B31.3 or ANSI B31.4 and/or ASME Section VIII Div.1. The Strainer body shall be fabricated steel or other specified material and inlet/outlet connections shall be in line. The Strainer shall have a single pleated basket. The screen shall be size \_\_\_\_ perforated stainless steel. The Strainer shall have an inlet size of \_\_\_\_ and open area ratio of \_\_\_\_\_. The Basket Strainer shall be SSI FB4.

## MATERIALS OF CONSTRUCTION (Carbon Steel Shown<sup>†</sup>)

Body .....	A53E/B or A106-B
Nozzles .....	A53E/B or A106-B
Flanges .....	A105
Heads .....	A234-WPB or A516-70
Couplings .....	A105
Plug .....	A105
Basket <sup>1</sup> .....	304 SS
Gasket <sup>1</sup> .....	304 SS Spiral Wound
Stud .....	A193-B7
Nut .....	A194-2H

† Other Materials Available. Consult factory.

1. Recommended Spare Parts.

Material specification will change when NACE MR01-75 is specified.

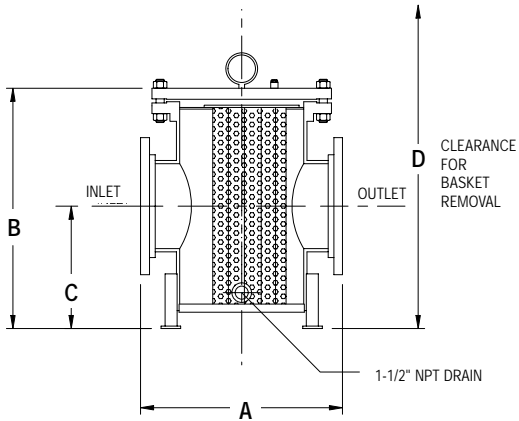

Standard Cover is bolted. Quick Opening Cover is available on request.

Cover lifting lug standard on bolted covers.

Class 125#/150# flanges standard.

Other Classes available on request.

Connections: 10"– 18" Flanged

## SCREEN OPENINGS

SIZE	STANDARD SCREEN	MATERIALS
10" – 12"	1/8 Perf. Pleated	304 SS
14" – 18"	3/16 Perf. Pleated	304 SS

FB4 FABRICATED  
BASKET STRAINERS

## FB4 DIMENSIONS inches (mm) and WEIGHTS pounds (kg)

For pressure classes greater than 150# consult factory.

Inlet/ Outlet	A	B	C	D	Weight	
					Cover <sup>1</sup>	Unit
10 (250)	23 (584)	29 (737)	12.19 (310)	47 (1194)	180 (82)	600 (272)
12 (300)	27 (686)	38 (965)	16.75 (425)	67 (1702)	220 (100)	1100 (499)
14 (350)	31 (787)	45 (1143)	18.75 (476)	77 (1956)	285 (129)	1300 (590)
16 (400)	31 (787)	45 (1143)	18.75 (476)	77 (1956)	430 (195)	1600 (726)
18 (450)	31 (787)	45 (1143)	18.75 (476)	77 (1956)	430 (195)	1800 (816)

Dimensions shown are for reference only. Consult factory for certified prints when required.

1. Weight and dimensions with Bolted Cover.

# FB SERIES – FB5 FABRICATED BASKET STRAINERS

## SPECIFICATION

Strainer shall be designed and manufactured to meet ANSI B31.1, ANSI B31.3 or ANSI B31.4 and/or ASME Section VIII Div.1. The Strainer body shall be fabricated steel or other specified material and inlet/outlet connections shall be in line. The Strainer shall have four independent baskets. The screen shall be size \_\_\_\_ perforated stainless steel. The Strainer shall have an inlet size of \_\_\_\_ and open area ratio of \_\_\_\_\_. The Basket Strainer shall be SSI FB5.

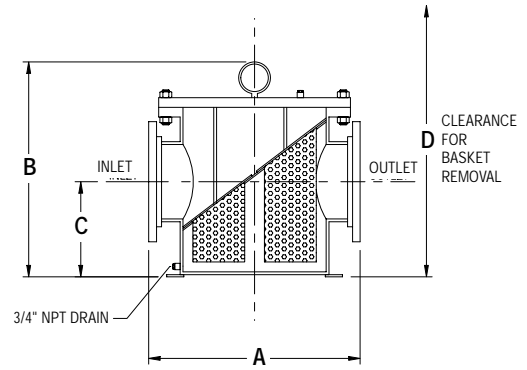

## MATERIALS OF CONSTRUCTION (Carbon Steel Shown<sup>†</sup>)

Body .....	A53E/B or A106-B
Nozzles .....	A53E/B or A106-B
Flanges .....	A105
Heads .....	A234-WPB or A516-70
Couplings .....	A105
Plug .....	A105
Basket <sup>1</sup> .....	304 SS
Gasket <sup>1</sup> .....	Non Asbestos
Stud .....	A193-B7
Nut .....	A194-2H

† Other Materials Available. Consult factory.

1. Recommended Spare Parts.

Material specification will change when NACE MR01-75 is specified.

Standard cover is bolted.

Cover lifting lug standard on bolted covers.

Class 125#/150# flanges standard. Class 300# available on request.

Connections: 8"– 36" Flanged

## SCREEN OPENINGS

SIZE	STANDARD SCREEN	MATERIALS
8" – 12"	1/8 Perf.-multi basket	304 SS
14" – 36"	3/16 Perf.-multi basket	304 SS

## FB5 DIMENSIONS inches (mm) and WEIGHTS pounds (kg)

For pressure classes greater than 150# consult factory.

Inlet/ Outlet	A	B	C	D	Weight	
					Cover <sup>1</sup>	Unit
8 (200)	23.35 (593)	20.13 (511)	9.13 (232)	38 (965)	180 (82)	750 (340)
10 (250)	26.13 (664)	23.75 (603)	11.38 (289)	44 (1118)	220 (100)	1100 (499)
12 (300)	29 (737)	28.38 (721)	14.63 (372)	52 (1321)	285 (129)	1500 (680)
14 (350)	30.5 (775)	31.25 (794)	16.75 (425)	60 (1524)	430 (195)	1900 (862)
16 (400)	33.5 (851)	35.5 (902)	19.13 (486)	66 (1676)	965 (438)	2400 (1089)
20 (500)	44.75 (1137)	46.25 (1175)	28.5 (724)	88 (2235)	1540 (699)	4500 (2041)
24 (600)	44.38 (1127)	52.25 (1327)	31.5 (800)	98 (2489)	1820 (826)	5900 (2676)
30 (750)	61.5 (1562)	66.5 (1689)	41.63 (1057)	125 (3175)	2240 (1016)	12100 (5489)
36 (900)	62 (1575)	66.5 (1689)	41.63 (1057)	125 (3175)	2240 (1016)	12400 (5625)

Dimensions shown are for reference only. Consult factory for certified prints when required.

1. Weight and dimensions with Bolted Cover.

FB5 FABRICATED  
BASKET STRAINERS

# FB SERIES

## FABRICATED BASKET STRAINERS

### PRESSURE DROP VS FLOW RATE

Water Service, Clean Basket, 1/32" - 1/4" Perforated Screen\*

**FB1**  
**FB2**  
**FB3**

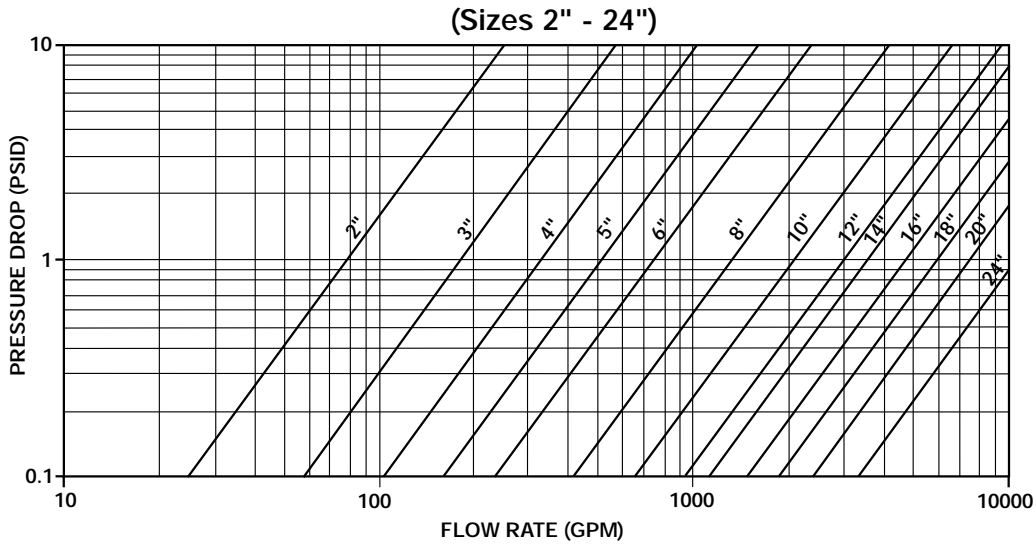

**FB FABRICATED BASKET STRAINERS**

**FB4**

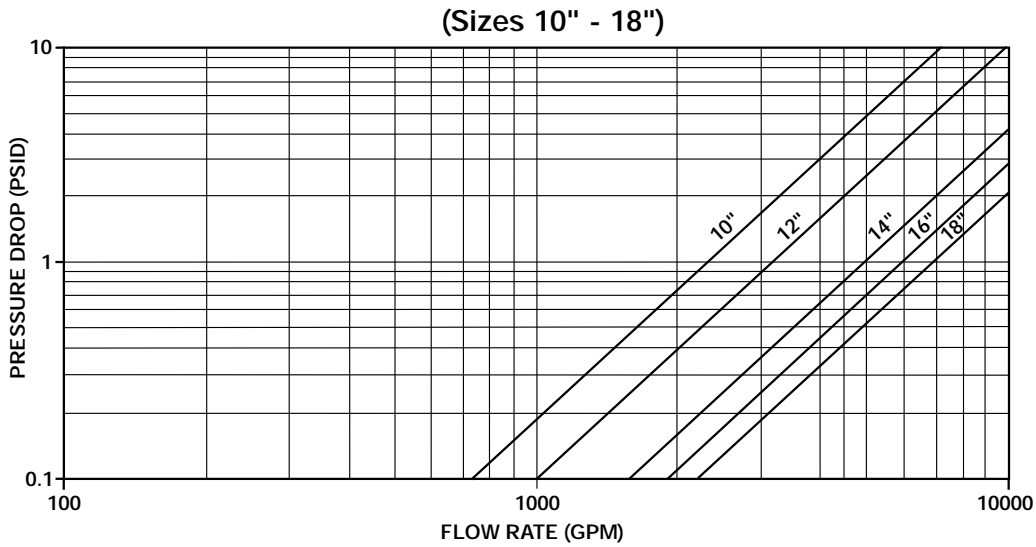

**FB5**

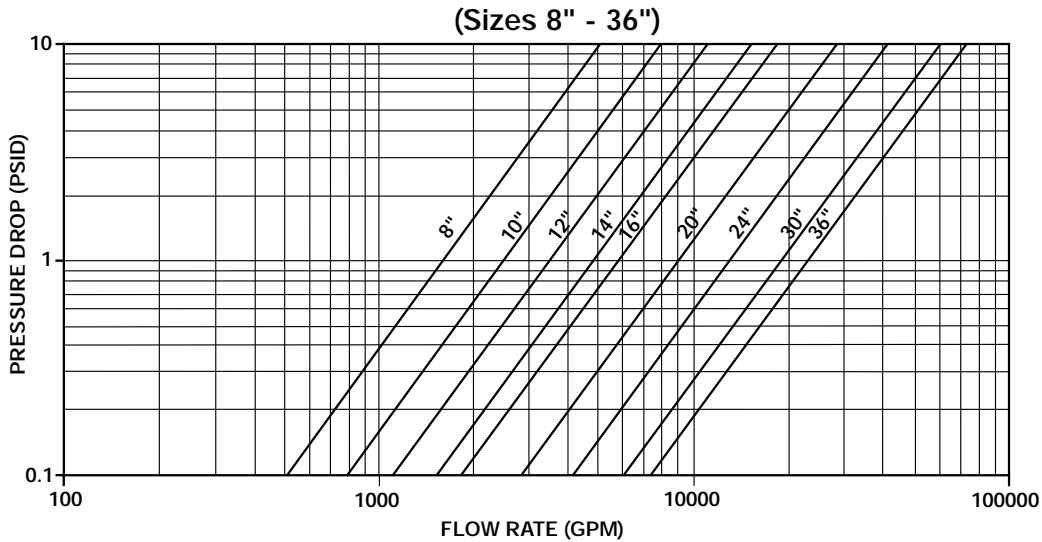

\* For Gas, Steam or Air service, consult factory.

# FB SERIES

## FABRICATED BASKET STRAINERS

### OPEN AREA RATIOS

**FB1**

Size	Opening diameter (in)	Opening %	Nominal Outlet Area (in <sup>2</sup> )	Gross Screen Area (in <sup>2</sup> )	Free Screen Area (in <sup>2</sup> )	Open Area Ratio (OAR)
2	1/8	40%	3.36	171	68	20.3
3	1/8	40%	7.39	266	106	14.4
4	1/8	40%	12.73	266	106	8.4
6	1/8	40%	28.9	377	151	5.2
8	1/8	40%	50.0	562	225	4.5
10	1/8	40%	78.9	938	375	4.8
12	1/8	40%	113.1	1179	472	4.2
14	3/16	50%	137.9	1429	715	5.2
16	3/16	50%	176.7	1940	970	5.5
18	3/16	50%	227.0	2166	1083	4.8
20	3/16	50%	277.9	3393	1696	6.1
24	3/16	50%	402.0	5150	2575	6.4

**FB2**

Size	Opening diameter (in)	Opening %	Nominal Outlet Area (in <sup>2</sup> )	Gross Screen Area (in <sup>2</sup> )	Free Screen Area (in <sup>2</sup> )	Open Area Ratio (OAR)
2	1/8	40%	3.4	78	31	9.3
3	1/8	40%	7.4	133	53	7.2
4	1/8	40%	12.7	133	53	4.2
6	1/8	40%	28.9	266	106	3.7
8	1/8	40%	50.0	451	180	3.6
10	1/8	40%	78.9	562	225	2.9
12	1/8	40%	113.1	703	281	2.5
14	3/16	50%	137.9	938	469	3.4
16	3/16	50%	182.7	1204	602	3.3
18	3/16	50%	227.0	1429	715	3.1
20	3/16	50%	291.0	1916	958	3.3
24	3/16	50%	402.0	3393	1696	4.2

**FB3**

Size	Opening diameter (in)	Opening %	Nominal Outlet Area (in <sup>2</sup> )	Gross Screen Area (in <sup>2</sup> )	Free Screen Area (in <sup>2</sup> )	Open Area Ratio (OAR)
2	1/8	40%	3.4	266	106	31.7
3	1/8	40%	7.4	350	140	19.0
4	1/8	40%	12.7	350	140	11.0
6	1/8	40%	28.9	562	225	7.8
8	1/8	40%	50.0	762	305	6.1
10	1/8	40%	78.9	1179	472	6.0
12	1/8	40%	113.1	1338	535	4.7
14	3/16	50%	137.9	1916	958	6.9
16	3/16	50%	176.7	3393	1696	9.6
18	3/16	50%	227.0	3393	1696	7.5
20	3/16	50%	265.2	5150	2575	9.7

**FB4**

Size	Opening diameter (in)	Opening %	Nominal Outlet Area (in <sup>2</sup> )	Gross Screen Area (in <sup>2</sup> )	Free Screen Area (in <sup>2</sup> )	Open Area Ratio (OAR)
10	1/8	40	78.85	800	320	4.1
12	1/8	40	113.1	1200	480	4.2
14	3/16	50	140.5	2000	1000	7.1
16	3/16	50	185.66	2000	1000	5.4
18	3/16	50	237.1	2000	1000	4.2

OAR = Free Screen Area / Nominal Inlet Area  
 Free Screen Area = Opening % x Gross Screen Area  
 Values shown are approximate. Consult factory for exact ratios.

**FB FABRICATED BASKET STRAINERS**

Open Area Ratios can be larger with custom basket designs. Contact factory when required.

For FB5 Open Area Ratios, consult factory.

Other Screen Openings Page 466	Basket Burst Pressure Page 472	Correction Factors for Other Viscous Liquids and/or Mesh Liners Page 471	Correction Factors for Clogged Screens Page 471
-----------------------------------	-----------------------------------	---	--

