



# Series G3-SS & CS

Seal Welded High Pressure  
Ball-Type Gauge Valves

## FEATURES



- Seal Welded Construction
- Full Port Design (Reduced Port on 2")
- Male Inlet has Schedule 80 Pipe I.D. on 1/2" to 1" sizes; Schedule 160 Pipe I.D. on 1-1/2" & 2" sizes
- 316 Ball & Stem Standard
- Fully Compliant to ASME B16.34, Class 1500
- Fully Compliant to API 608, Class 1500
- NACE MR01-75 Compliant
- Standard ISO 5211 Mounting Pads
- Standard 304SS Latch-Lock Handles
- (2) 1/2" NPT Gauge Ports on Outlet Side
- Standard PEEK Seats
- API 607 4th Edition Fire Safe
- 3600 PSIG Rating (CF8M); 3705 PSIG Rating (WCB)

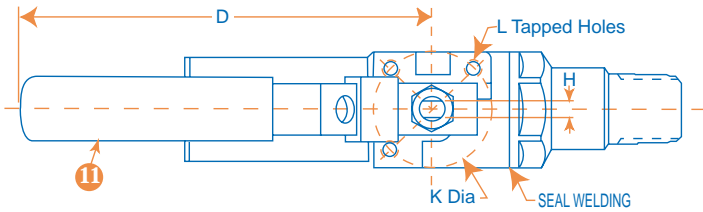

## RATINGS

3600 PSIG @ 100F Water, Oil, Gas (CF8M)  
3705 PSIG @ 100F Water, Oil, Gas (WCB)  
250 PSIG Saturated Steam

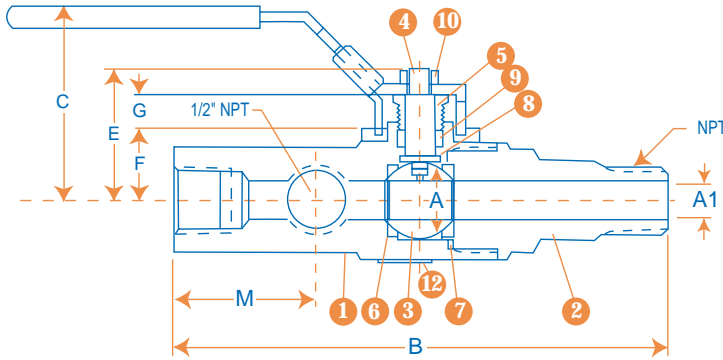

## MATERIALS OF CONSTRUCTION

PART	DESCRIPTION	STANDARD MATERIAL
1	BODY	CF8M or WCB
2	TAILPIECE	CF8M or WCB
3	BALL	ASTM A276 GR. 316SS
4	STEM	316SS or 17-4PH (1-1/2-2")
5	PACKING NUT	ASTM A276 GR. 316SS
6	SEATS (2)	PEEK
7	TAILPIECE SEAL	GRAPHITE
8	THRUST WASHER	PEEK
9	STEM PACKING	GRAPHITE
10	HANDLE NUT	304 SS
11	HANDLE ASSY.	304 SS
12	NAME PLATE	300SS

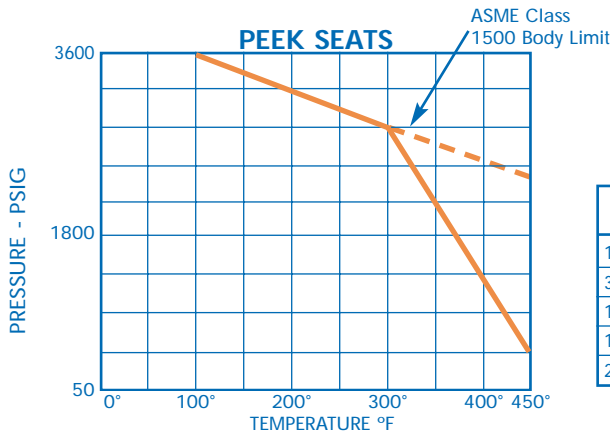

## DIMENSIONS, WEIGHTS, CV FACTORS & MAXIMUM OPERATING TORQUE

SIZE	A	A1	B	C	D	E	F	G	H	J	K	L	M	ISO Pattern	WEIGHT Lbs	Cv	MAX. TORQUE (in-lb)
1/2"	.50	.50	6.0	2.3	5.0	1.62	.89	.33	.20	.31	1.42	1/4"-20 UNC	1.75	F03	1.8	16	140
3/4"	.75	.74	7.2	2.9	5.8	2.21	1.29	.41	.28	.43	1.65	1/4"-20 UNC	1.75	F04	3.7	32	270
1"	1.00	.96	8.5	3.5	7.4	2.80	1.65	.43	.35	.56	1.97	1/4"-20 UNC	2.00	F05	6.6	62	700
1-1/2"	1.50	1.34	9.5	4.5	13.9	3.87	2.51	.49	.39	.62	2.76	5/16"-18 UNC	2.00	F07	14.5	140	1200
2"	1.50	1.69	9.9	4.5	13.9	3.87	2.51	.49	.39	.62	2.76	5/16"-18 UNC	2.36	F07	15.5	120	1200

# Quadrant<sup>®</sup>

VALVE & ACTUATOR, LLC

REV. 06/04

## SERIES G3-SS & CS

NUMBERING SYSTEM ... HOW TO ORDER:

**G3 F S S P G SL MT 100**

SERIES	PORT SIZE	BODY MATERIAL	BALL/STEM MAT'L	SEAT MAT'L	SEAL MAT'L	HANDLE TYPE	ENDS	SIZE
G3 = SEAL WELDED 3600 WOG	F = FULL R = REDUCED (2" Size)	S = STAINLESS (CF8M) C = CARBON (WCB)	S = 316 STAINLESS A = ALLOY 20 H = HASTELLOY	P = PEEK	G = GRAPHITE	SL = STAINLESS LATCH LOCK PA = DOUBLE ACTING PNEUMATIC SA = SPRING RETURN PNEUMATIC SR = DEADMAN HANDLE EA = 115VAC ELECTRIC ACTUATED	MT = MALE NPT X FEMALE NPT	050 = 1/2" 075 = 3/4" 100 = 1" 125 = 1-1/4" 150 = 1-1/2" 200 = 2"

M2 Series  
with  
Extended  
Topworks



S10-SS  
10,800WOG  
Seal Welded  
Ball Valve

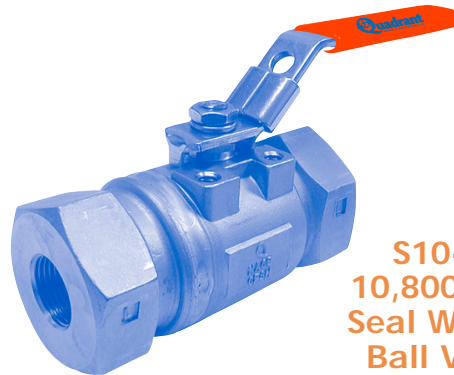

2" Series F1  
Unibody  
Flanged Ball  
Valve



6" x 4" Class 600  
F2 Series

